



Water Temperature Control Pack CCS14KWV2

KEY BENEFITS >>>

- > The mixed water flow temperature can be adjusted within the range of 20-55°C
- > 'A' rated Wilo Para 25/6 SCU pump
- > Integrated Isolation & check valves for easy filling
- > Temperature gauge
- > Assembled in the UK: pre-tested, packaged and ready for instant installation
- > 2 Year warranty
- > Fully reversible (Left or Right sided manifold)
- > Side or bottom entry connections



PRODUCT LIST >

DESCRIPTION	QTY	PRODUCT CODE
Compact Control Set - 14KW	1	CCS14KWV2

< OVERVIEW

Suitable for up to 14kw heating load compact lightweight thermostatic mixing control complete with Wilo pump.

The unit has been designed for direct connection to heating manifolds with 210mm manifold bar dimensions and is supplied fully assembled in left hand format with G1" swivel nuts with O rings as standard.

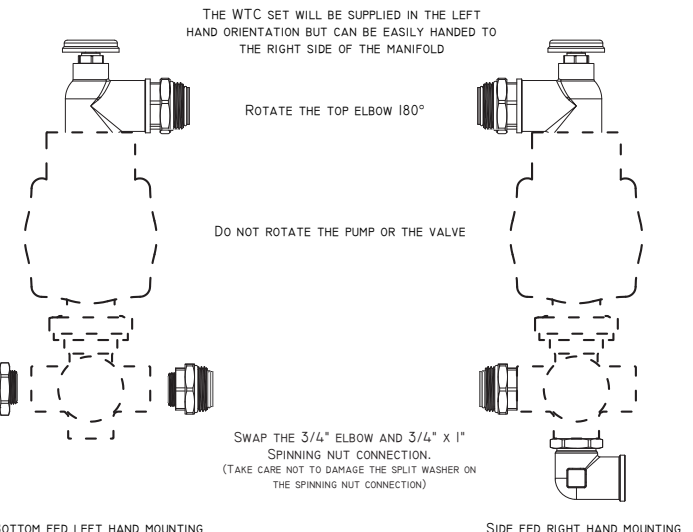
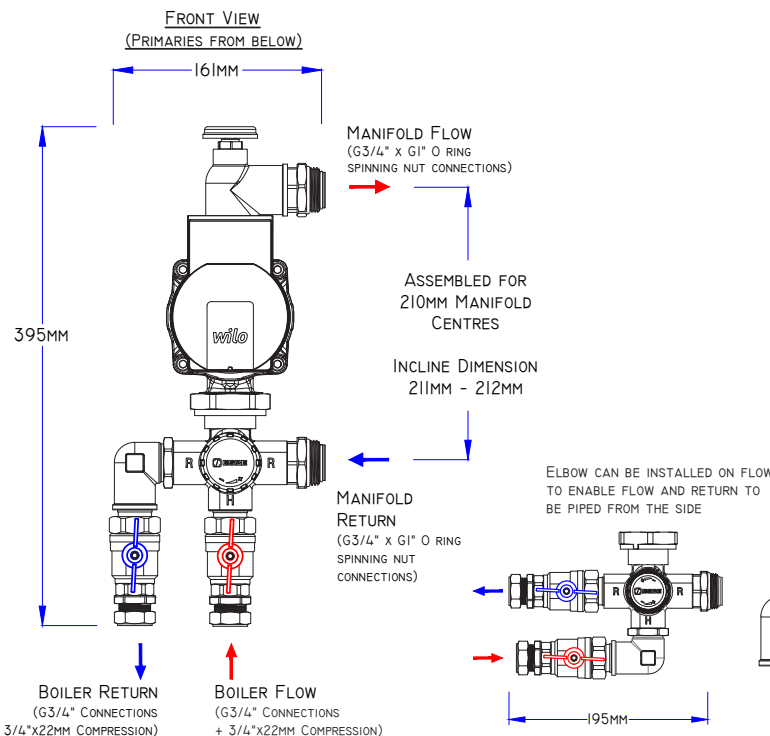



Water Temperature Control Pack

CCS14KWV2

PUMP DETAILS >

PUMP OPERATING MODES

- > **Proportional Pressure**
Not recommended for underfloor heating
- > **Constant Pressure**
Recommended for underfloor heating for large-sized pipes or all applications without a variable pipe network curve (e.g. storage charge pumps), as well as single-pipe heating systems with radiators. The control keeps the set delivery head constant irrespective of the pumped volume flow.
- > **Constant Speed**
There are three pre-defined pump curves (I, II, III) to choose from. Recommended for systems with fixed system resistance requiring a constant volume flow. The pump runs in three prescribed fixed speed stages (I, II, III).

Note: Factory setting: Constant speed, pump curve III

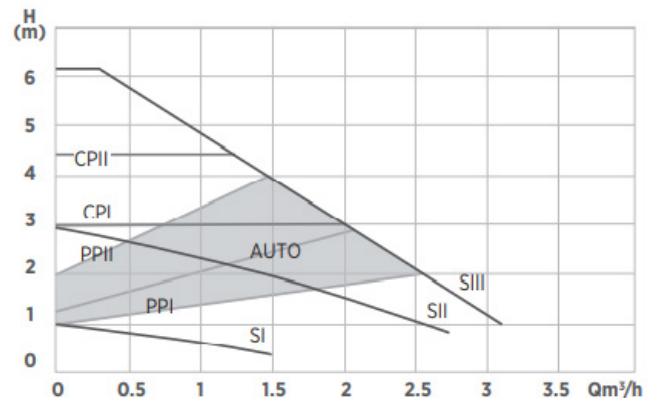

TECHNICAL DETAILS >>

Maximum static pressure	10 Bar
Maximum differential pressure	3 Bar
Maximum temperature	95°C
Operating temperature range	Adjustable between 20°C to 55°C (BS2164)
Inlet connections	2 x 3/4" BSPF
Outlet connections	2 x 1" BSPM swivel joint
Overall dimensions (mm)	290 h x 150 w x 140 h
Kvs	3.4
Material	Nickel plated brass

TEMPERATURE SETTING >>>

Setting Number	1	2	3	4	5	6
Temperature (°c)	20	27	34	41	48	55